

How to Optimize Display for Lumeo System on Hospital Laptops

(For users who anticipate that they may document on their laptops on patient units)

- 1) Close Lumeo, log out of Citrix.
- 2) Once logged out of Citrix, go to the carat (^) at the bottom of the screen (see screenshot).

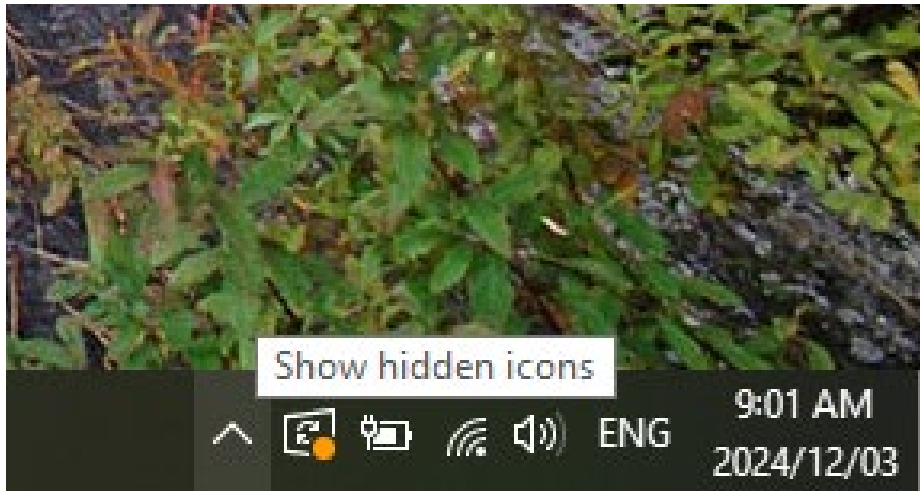

- 3) Right-click the Citrix Workspace icon (see screenshot).

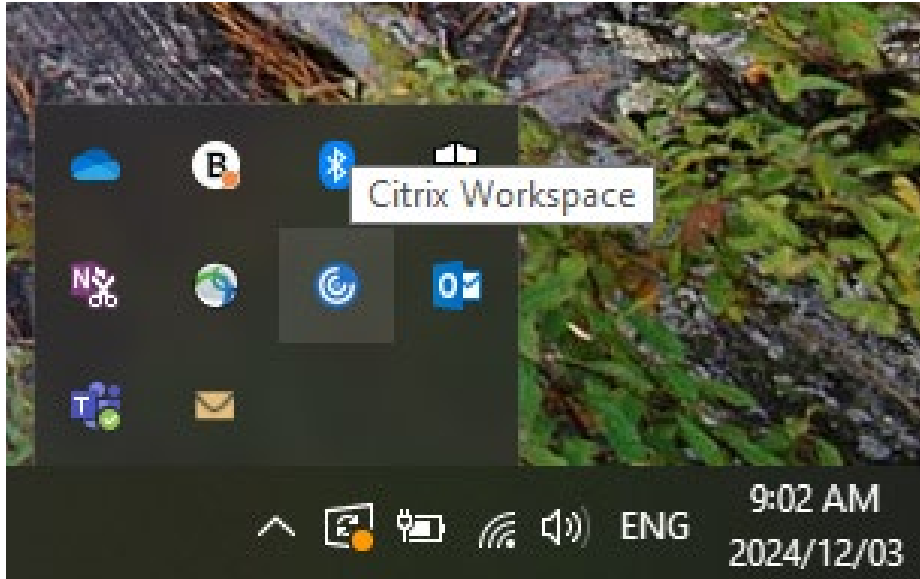

4) Select 'Advanced Preferences' from the box that appears (see screenshot).

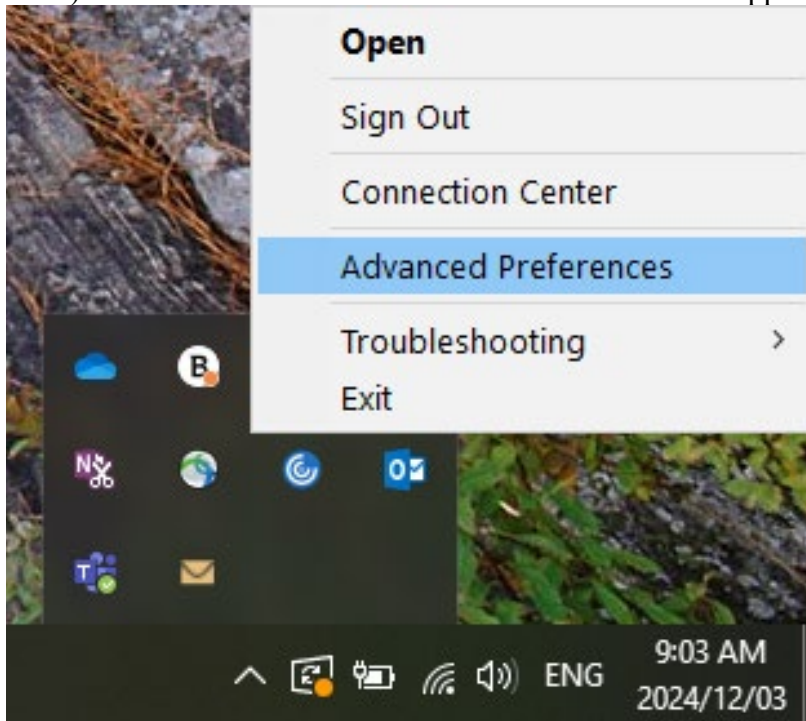

- 5) A new window will appear, titled Citrix Workspace Advanced Preferences. Select 'High DPI' (see screenshot).

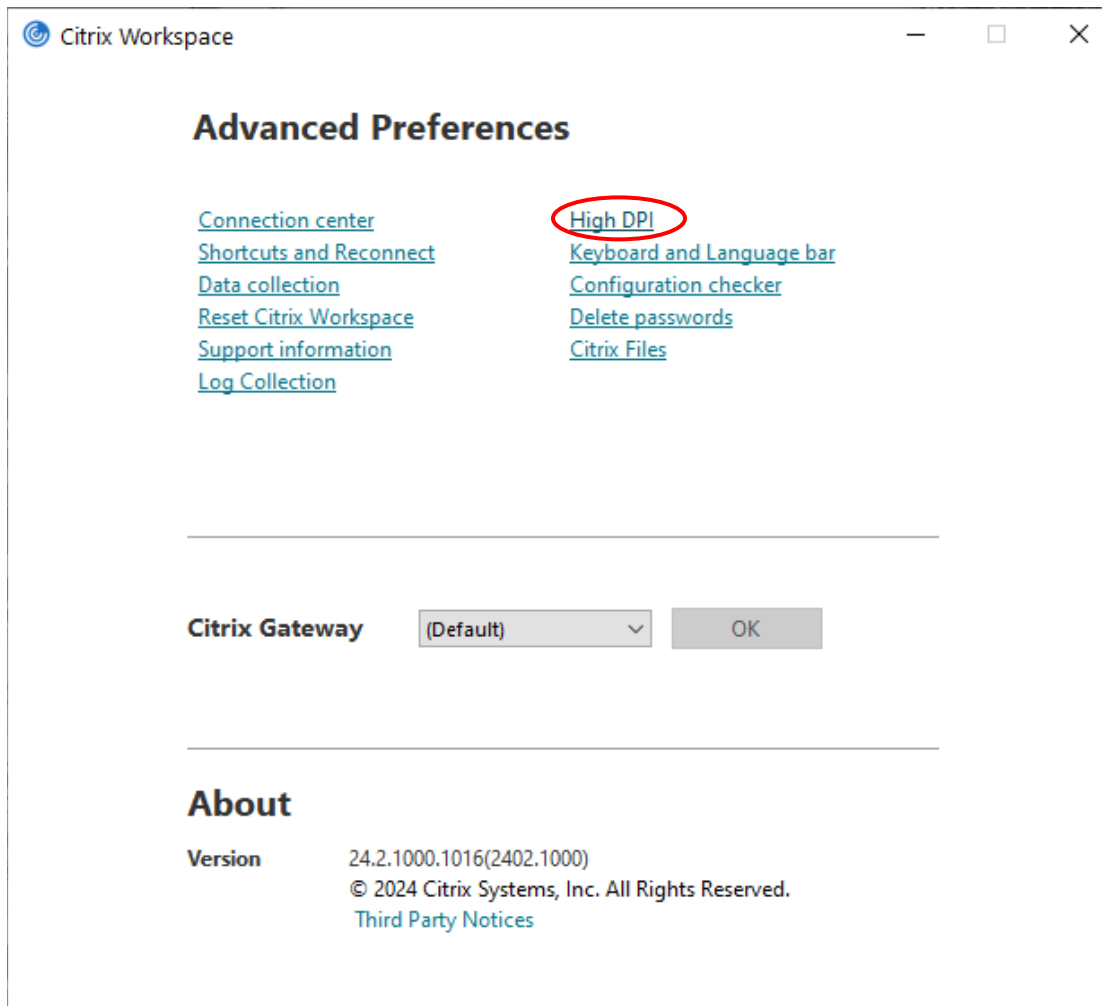

- 6) A second window will appear. Select “Let the operating system scale the resolution”, and then hit ‘Save’ (see screenshot).

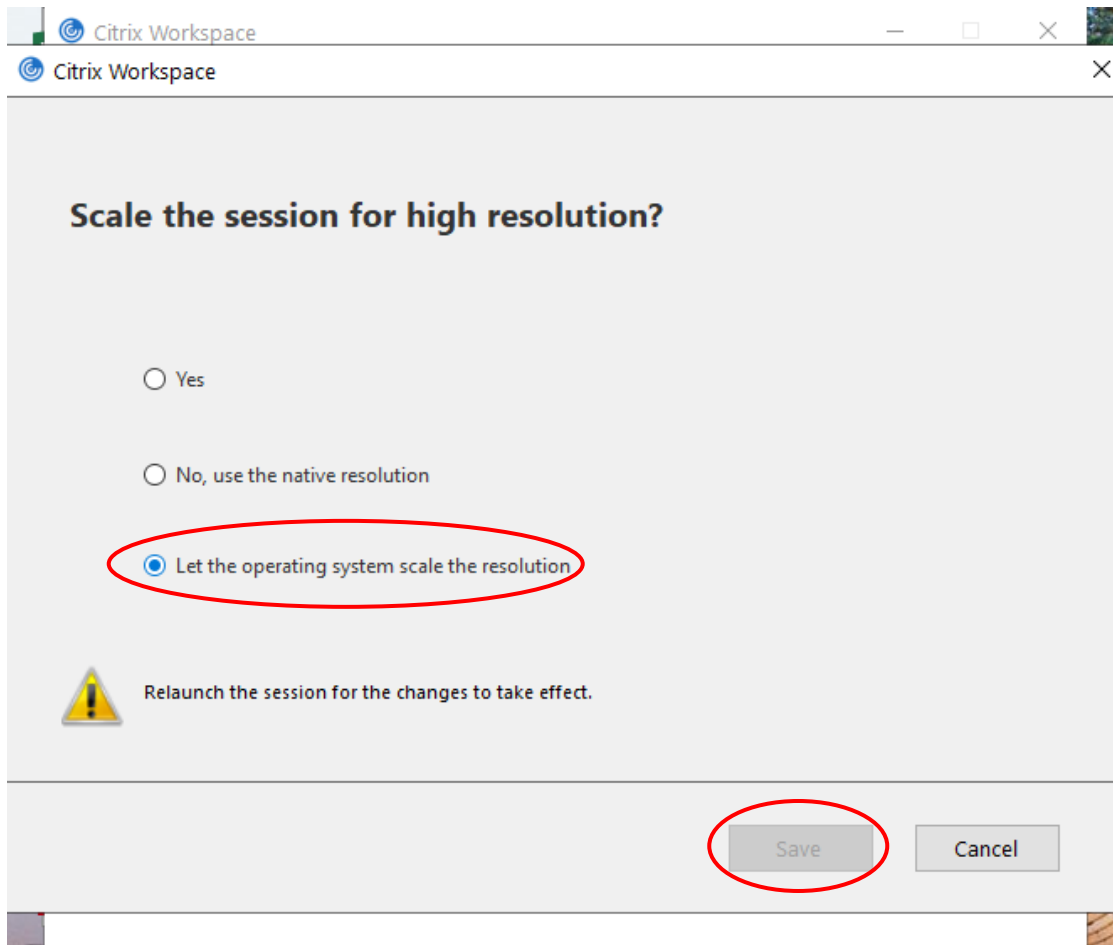

- 7) You may now exit out of the Advanced Preferences for Citrix Workspace by clicking the red X (see screenshot).

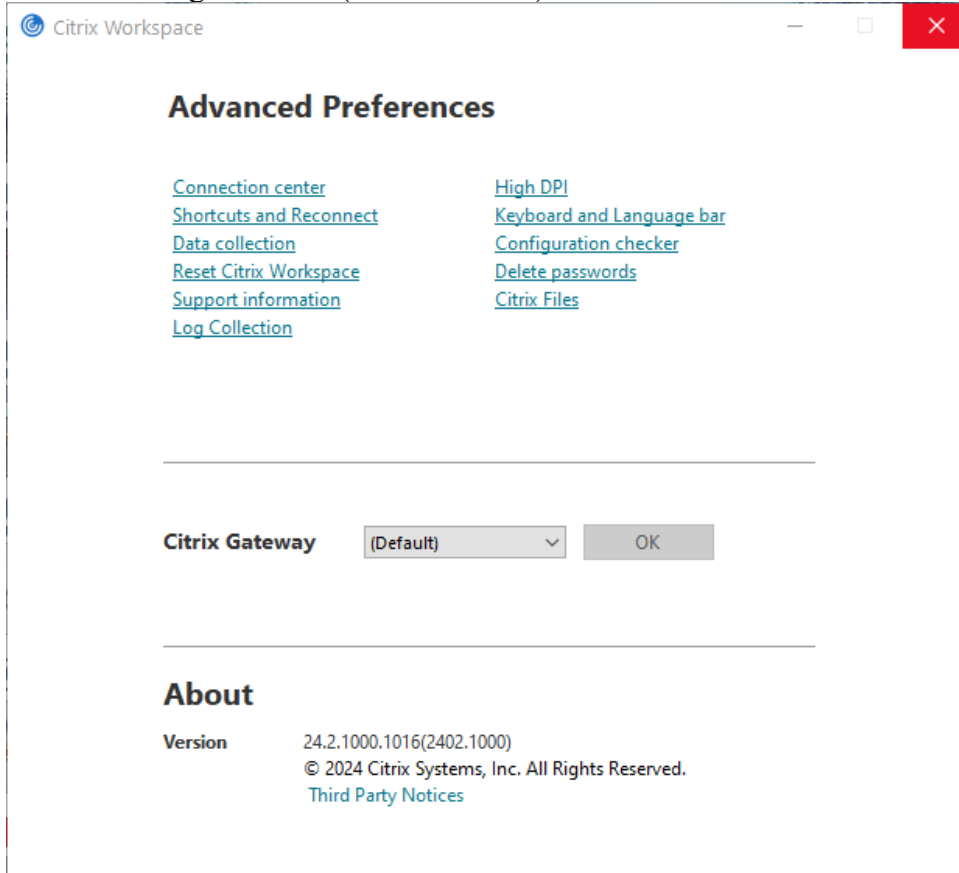

- 8) Now, you can log in to Citrix and Lumeo. Your Lumeo System should now display text at a comfortable size for reading. All data should display appropriately within PowerForms.

For further troubleshooting with respect to display settings on laptops for Lumeo, please contact your PPL and/or IT services.